

SSX CONNECTOR SERIES

NEW ROUNDED EDGE FEMALE CONTACTS SEAMLESS MATING AND SUPERFAST CONTACT INSERTION



A benchmark set on mechanical perfection

The new design of the standard SSX female contacts features a rounded shape of the contact entry ports and allows smooth contact insertion inside the insulating insert with no damages on the pin cavities and positive contact placement and retention.

The new design of the standard female contacts eliminates the need to use lubricants or guide pins to insert the contacts, greatly reducing assembling time.

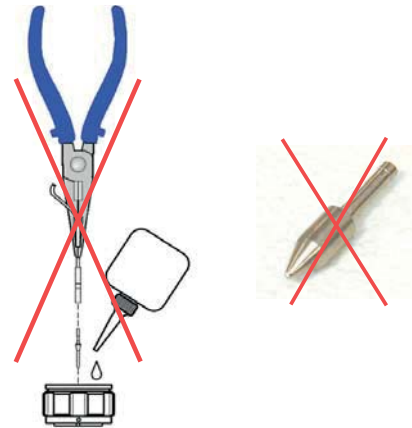

CONTACTS

The male and female are machined high conductive alloy and are gold or silver plated.

CRIMP

Voltage rating AC	Voltage rating DC	Max current	Rated current	Potential drop	Dielectric Strength	
					Test voltage	Min. Flashover
700 V	500 V	41 Amps	23 Amps	63 mV	2000 Vac RMS	2800 Vac RMS



GOLD Male



SILVER Male



GOLD Female



SILVER Female

SOLDER

Voltage rating AC	Voltage rating DC	Max current	Rated current	Potential drop	Dielectric Strength	
					Test voltage	Min. Flashover
700 V	500 V	41 Amps	23 Amps	63 mV	2000 Vac RMS	2800 Vac RMS



GOLD Male



SILVER Male



GOLD Female



SILVER Female

ADVANCED EARTH CONTACTS



As a standard, all SSX connectors are equipped with the 7 central contacts in an advanced position to obtain "first make last break" ground contact.

COMMON GROUND



Part N.: **SSXCMGRG (Gold) - SSXCMGRS (Silver)**
Two rings can be fitted to the central contacts to create common grounding of the 6 circuits' earths. (OPTIONAL)